



2022

COURY CLONE PINOT NOIR

Bottle Price: \$64 | 800 Cases Produced



TASTING NOTES BY WINEMAKER, BRIAN IRVINE

This striking beauty embodies what Hyland Pinot is all about. Delicate aromas of strawberry and warm vanilla fill the air. Followed by flavors of spiced plum, strawberry rhubarb pie, and sous bois to create an evocative taste, where you dream of the holidays.

APPELLATION

Mcminnville AVA, Willamette Valley

VARIETAL COMPOSITION

100% Pinot Noir

ÉLEVAGE

Aged for 10 months in barrel -
30% new French oak

HARVEST

October 4, 2021

Alcohol

13.2%

VINTAGE OVERVIEW

It seems like Mother Nature throws us a curveball during every growing season, and 2022 was no different. In mid-April, post-bud-break, a cold front brought record-low temperatures and frost into the Willamette Valley, leaving many to wonder if there would be a crop to harvest come Fall. In average years, Hyland's slightly higher elevation lends itself to a delayed start to the growing season compared to the rest of the valley. The delayed start greatly benefited the vineyard in 2022 as it could go mostly unaffected by the cold weather. July through September was unusually warm and helped give the vines the boost they needed to get back on track. Ideal conditions continued into October, allowing the fruit extra weeks of hangtime not typically seen in recent vintages.

Vintage Overview



HYLAND

ESTATES

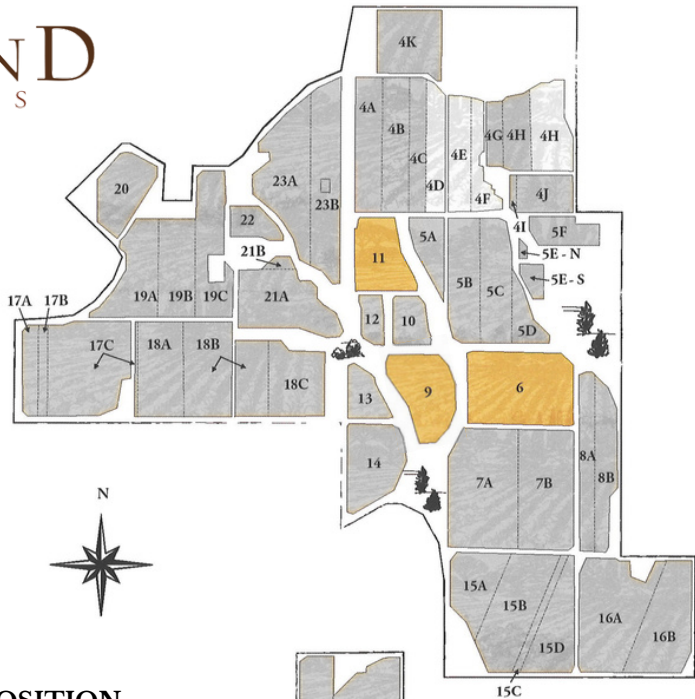

VINEYARD COMPOSITION

This wine is what we like to think of as a pure expression of history. It is comprised of a mixture of original, old blocks from the Hyland Vineyard, and some newer plots on the property. This Pinot Noir is a select blend of the renowned Coury clone, all grown in Volcanic Jory clay soil and nestled in the foothills of the Coastal Range.

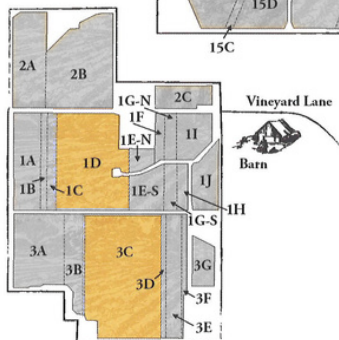

BLOCK	VARIETY	CLONE	ACREAGE	PLANTED
1D	Pinot Noir	Coury	6.22	1971
3C	Pinot Noir	Coury	8.65	1974
6	Pinot Noir	Coury	5.50	1989
9	Pinot Noir	Coury	3.07	1997
11	Pinot Noir	Coury	3.26	1998